

SINALIZAÇÃO VERTICAL

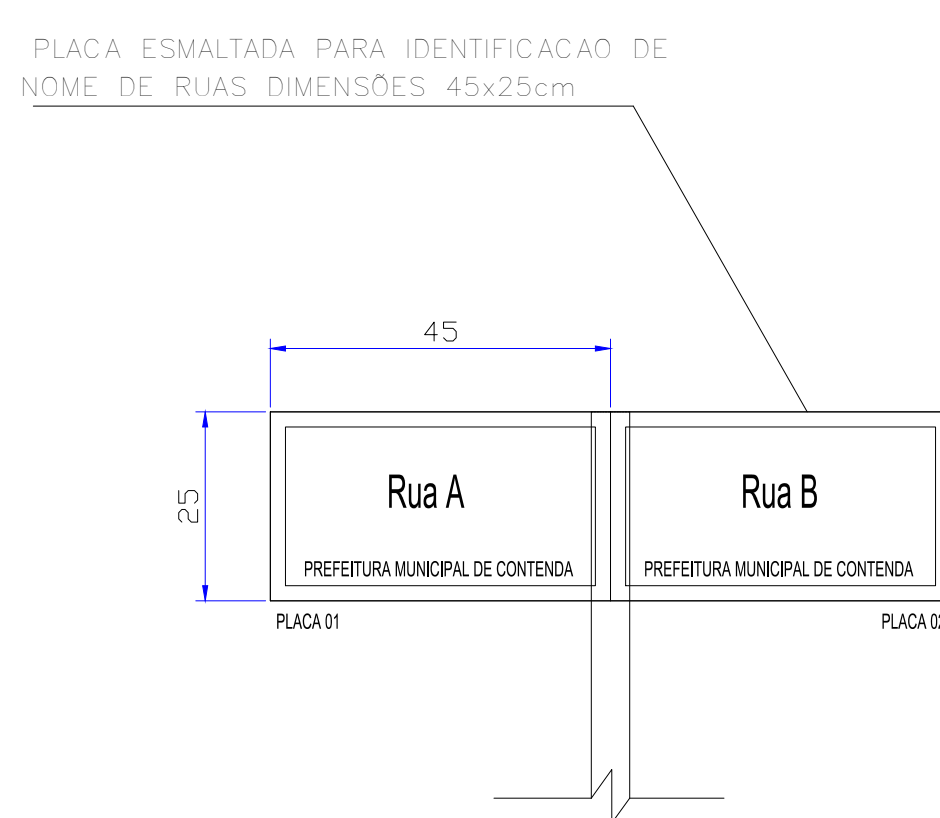

PARE

DETALHE DE PLACA DE SINALIZAÇÃO
Escala: 1/10

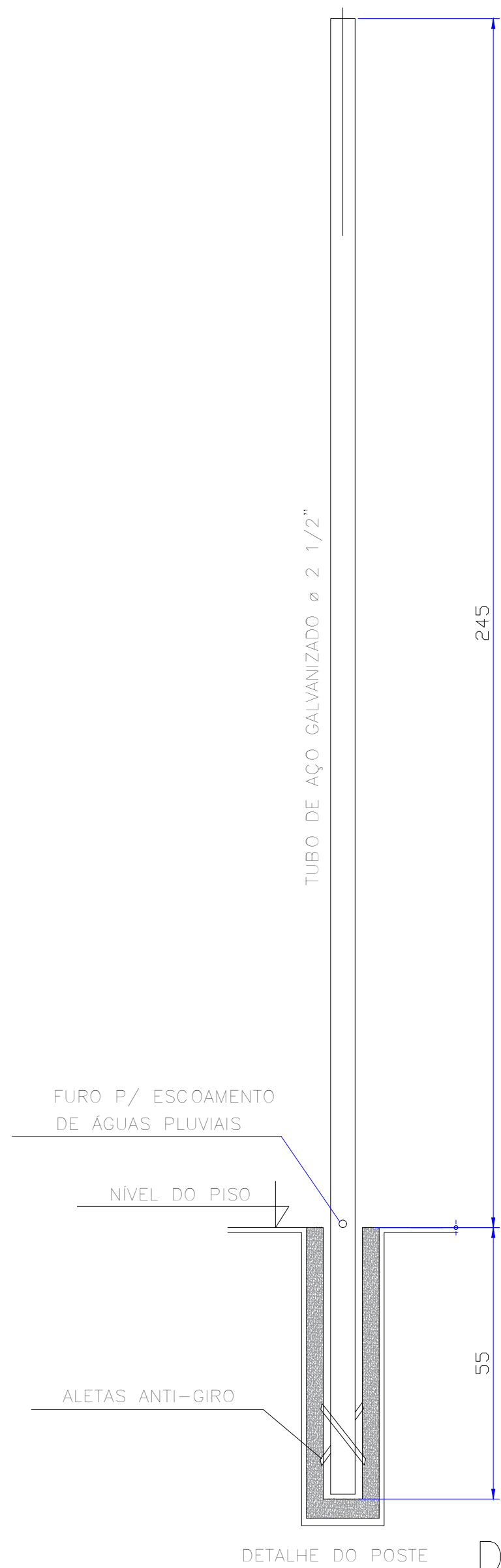

DETALHES DAS PLACAS

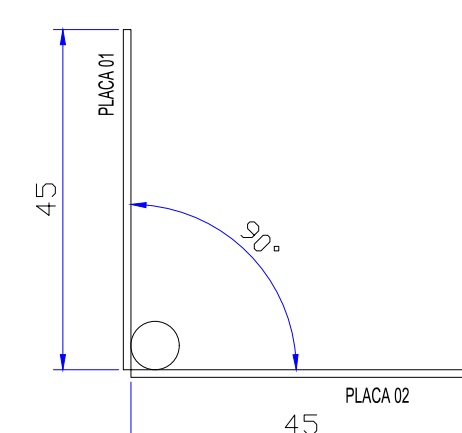

VISTA SUPERIOR

DETALHE DE PLACA DE IDENTIFICAÇÃO DE RUAS
Escala: 1/10

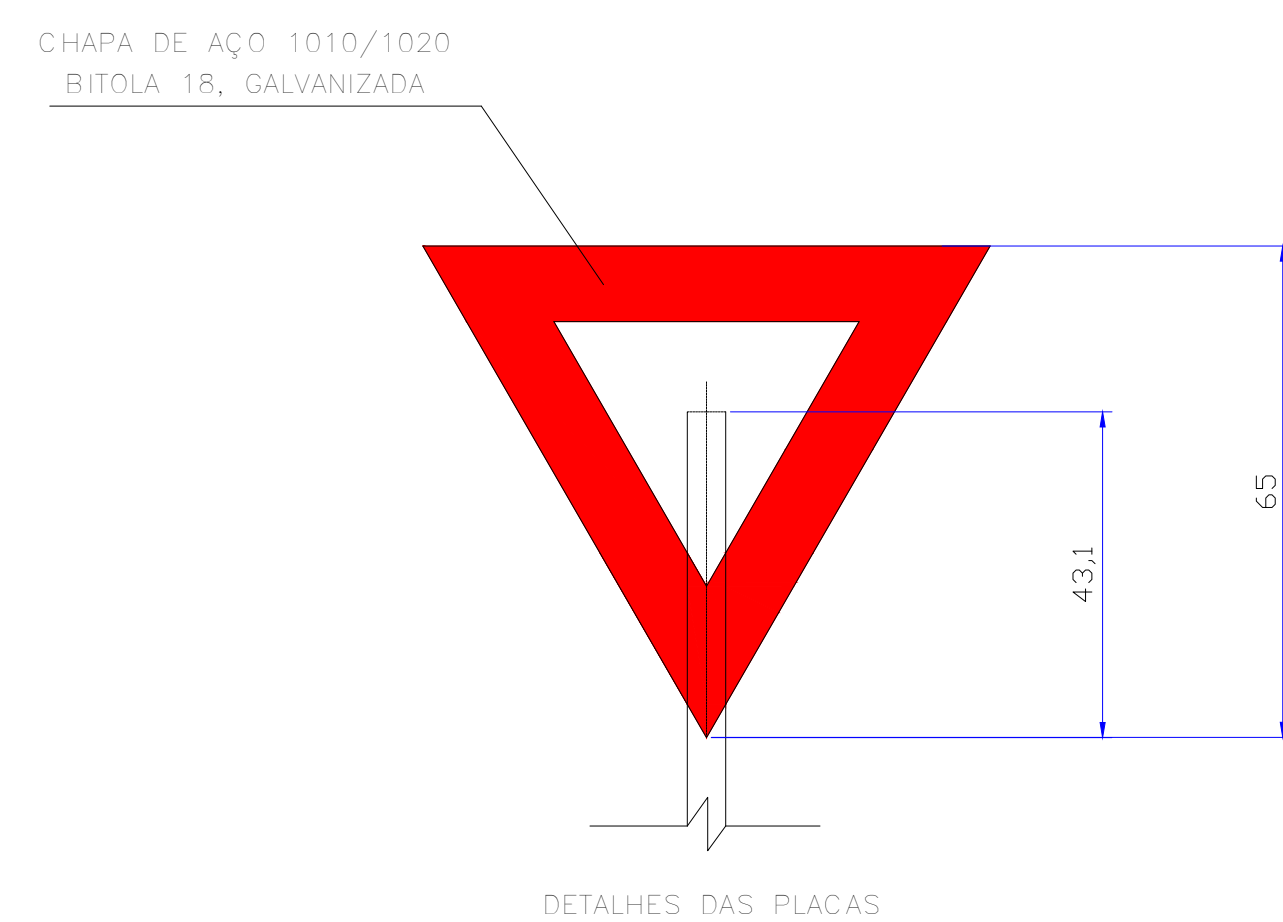
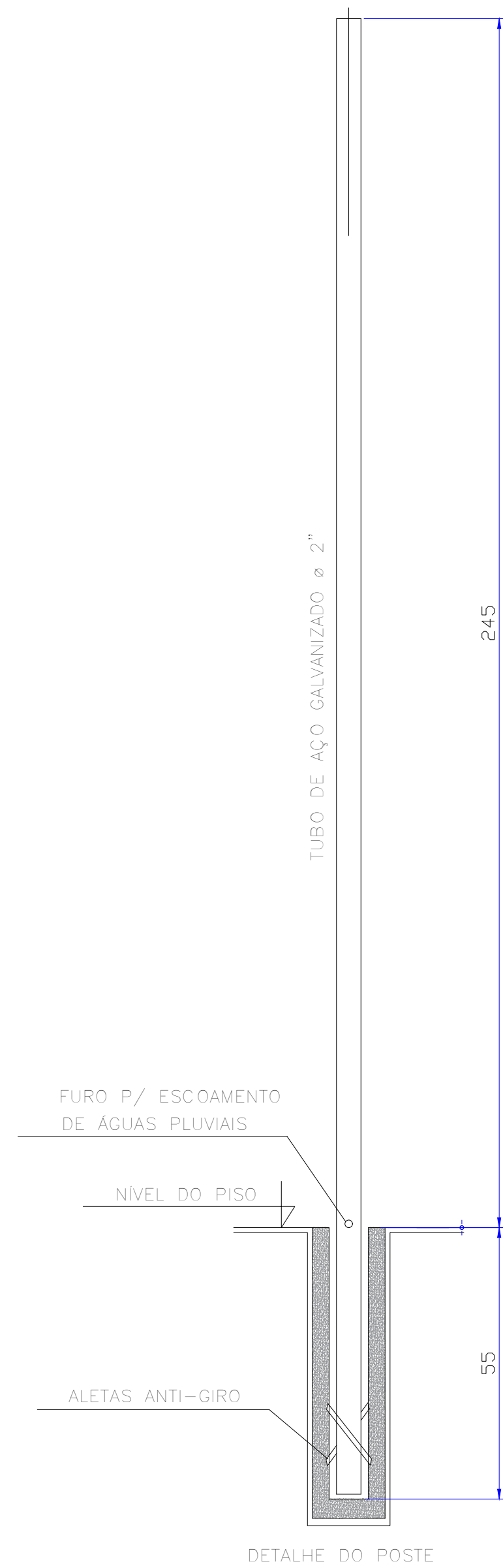

SINALIZAÇÃO VERTICAL

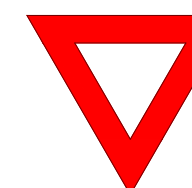

PREFERENCIAL

DETALHE DE PLACA DE SINALIZAÇÃO
Escala: 1/10

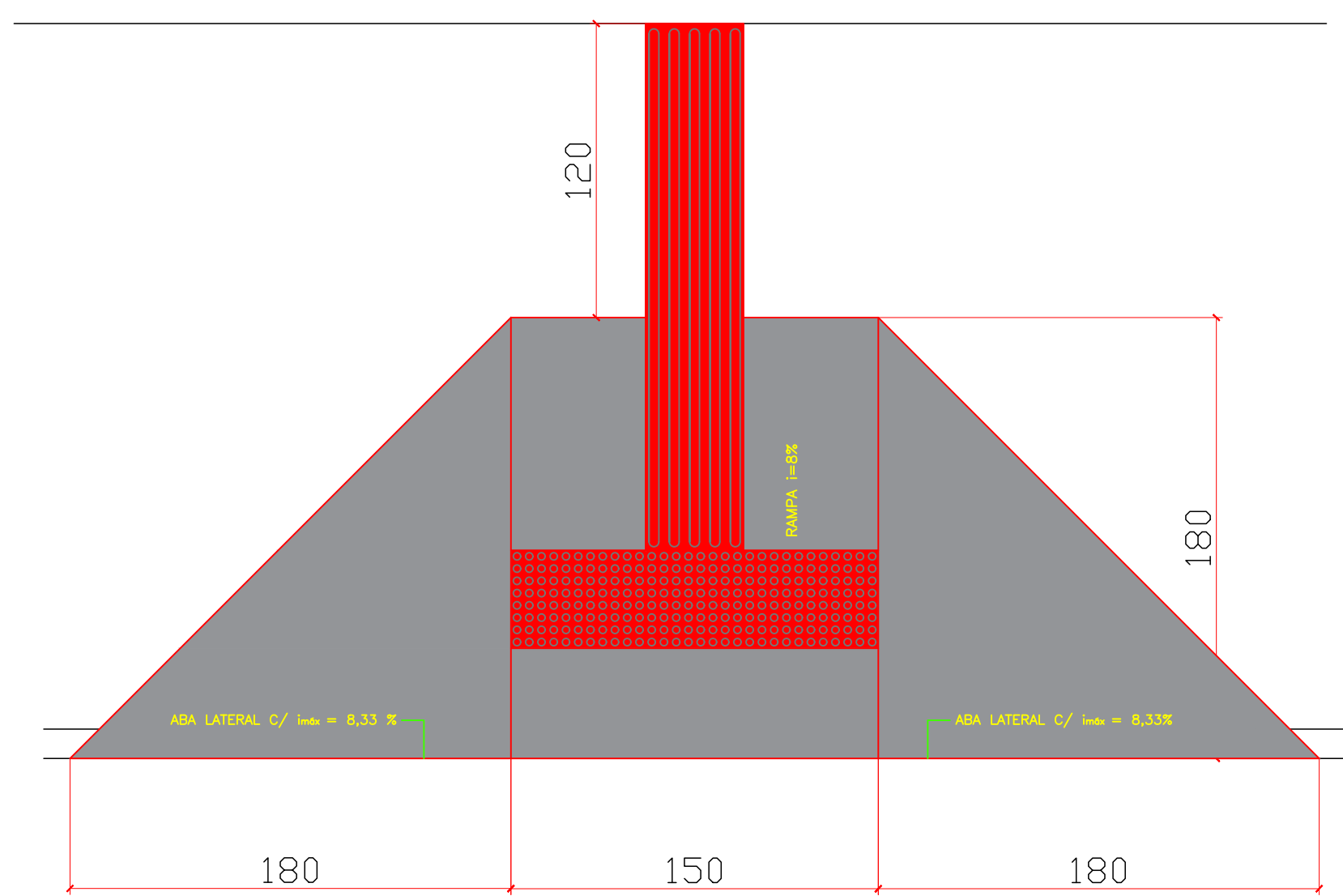

DETALHE DA RAMPA
Escala: 1/25

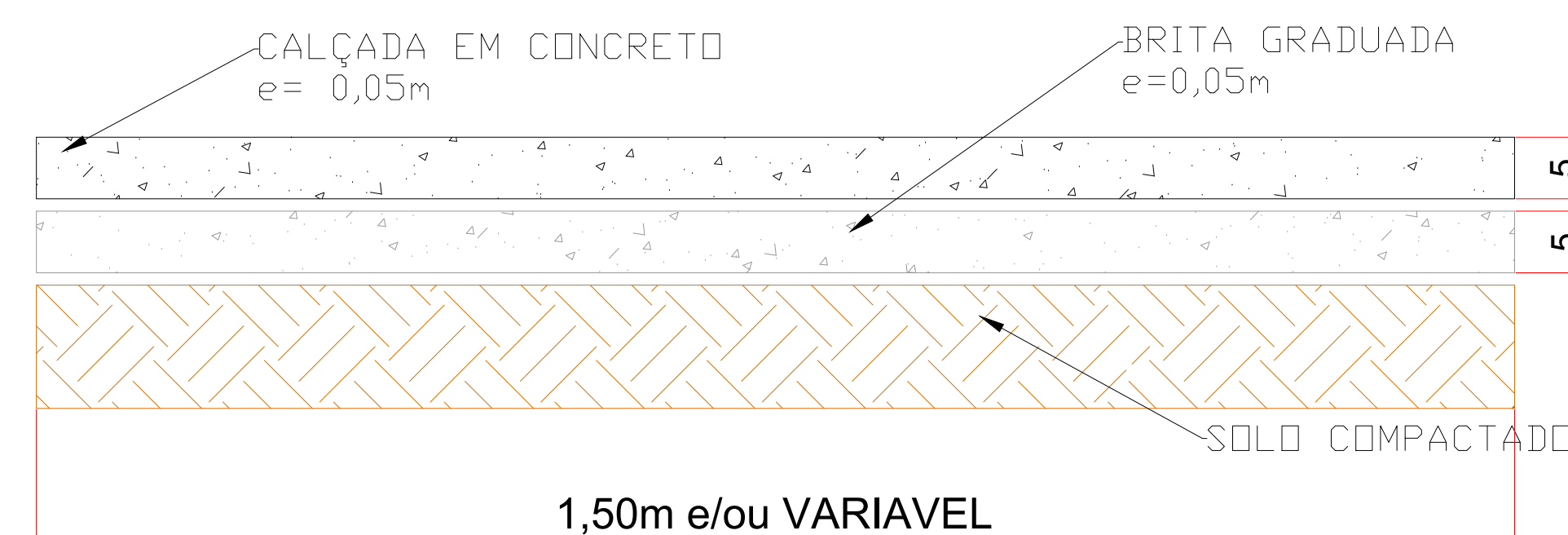

DETALHE CALÇADA
Escala: 1/5

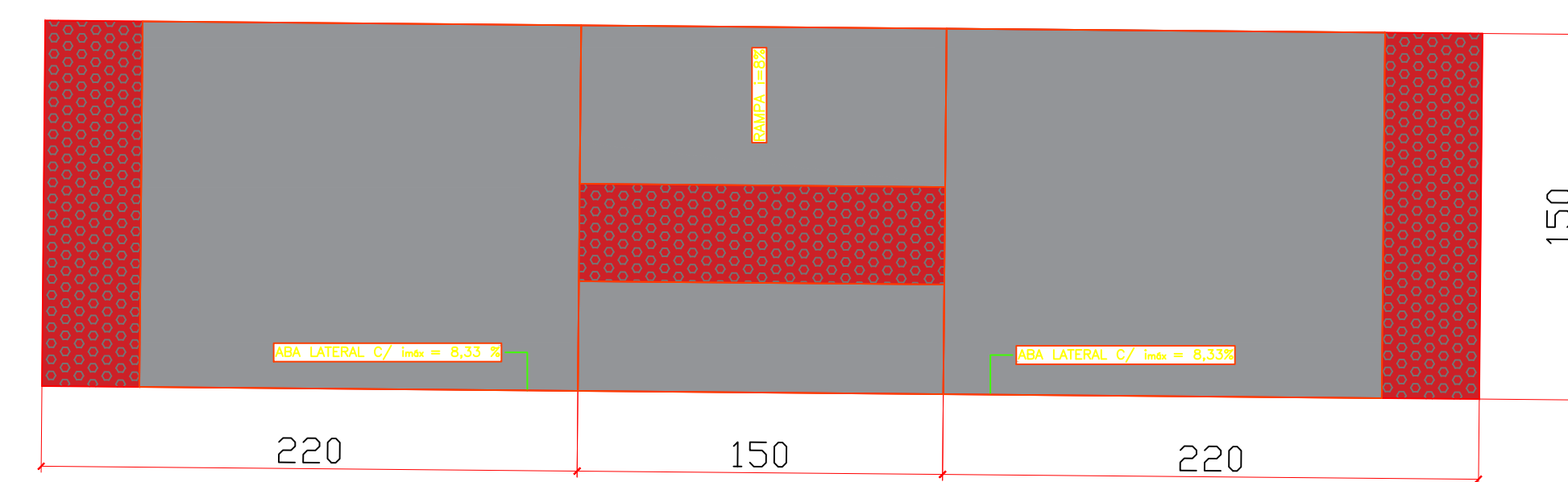

DETALHE DA RAMPA
Escala: 1/25

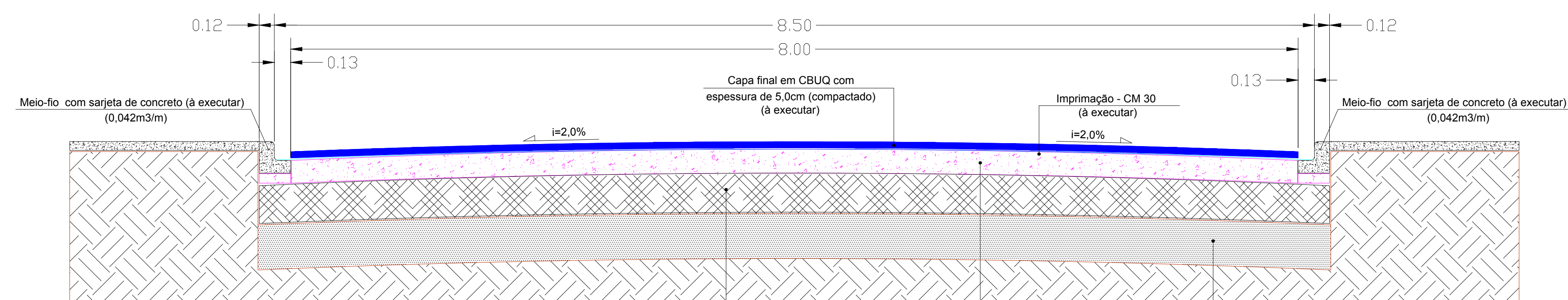

PERFIL TRANSVERSAL - Seção C-C'
(Rua Estefano Graboski)
Esc.: 1/25

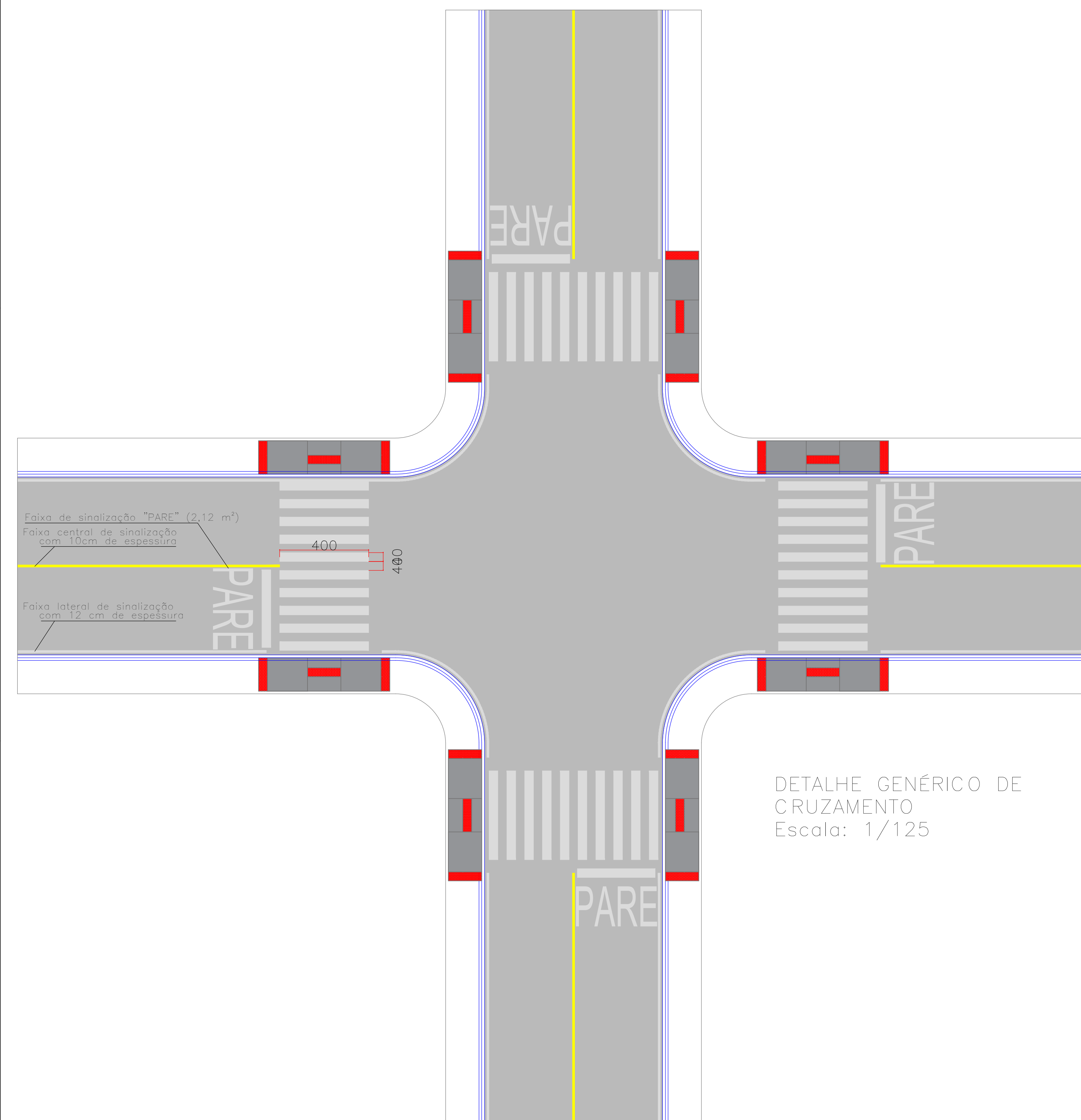

DETALHE GÊNICO DE CRUZAMENTO
Escala: 1/125

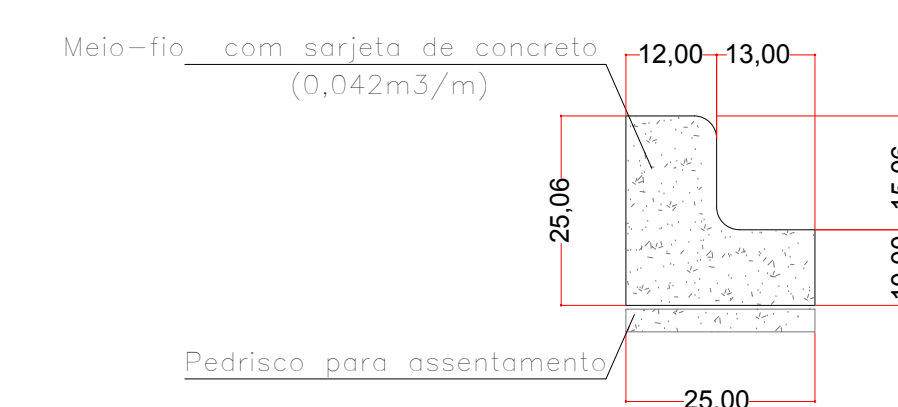

DETALHE DO MEIO-FIO
Escala: 1/10

PREFEITURA MUNICIPAL DE CONTENDA - PR.

Endereço: Av. João Franco,
400, Centro
Contenda - Pr



OBRA
PAVIMENTAÇÃO EM C.B.U.Q. DA AV. ESTEFANO GRABOSKI

RESP. TÉCNICO PROJETO
OVIDIO LUIZ DRUSZCZ
ENF. CIVIL - CREA PR - 102260

ASSINATURA

RESP. TÉCNICO EXECUÇÃO

ASSINATURA

ESCALA

INDICADA

DATA

FEBREIRO/2018

PROJETA

ENF. OVIDIO

DESENHO

RUBENS

CONTEÚDO

DETALHES

FOLHA

04/05

CARLOS EUGENIO STABACH

PREFEITO MUNICIPAL

ASSINATURA